

TECHNICAL DATA SHEET

BALKEN INOX STAINLESS STEEL PUSH TROLLEY

MODEL: MTS



FEATURES:

- Maximum protection against corrosive and high humidity environments.
- Suitable for cleanrooms and food-industry applications.
- All parts (except bearings) made from highly corrosion resistant 304(V2A) stainless steel. Bolts made from 2Cr13 stainless steel.
- Customisable by adjusting the spacers.
- Safety bars serve as fall, breaking & impact protection. Additionally equipped with tilting protection.
- Permanently lubricated, ball bearing mounted wheels allow for smooth traversing.
- Suitable for most I- and H-beam profiles.
- Complies with the Machinery Directive 2006/42/EC. Supplied with test certificate, CE declaration of conformity and operating instructions.



TECHNICAL DATA SHEET

BALKEN INOX STAINLESS STEEL PUSH TROLLEY

MODEL: MTS

SPECIFICATIONS

SPECIFICATIONS	
Operating Temperature	-10°C - +60°C
Load Type	Goods may not be used to lift people

PRODUCT CODE	CAPACITY kg	TEST LOAD ton	SUITABLE BEAM WIDTH mm	MINIMUM RADIUS m	WHEEL DIAMETER mm	NET WEIGHT kg
MTS-0-50	500	0.74	50-152	0.8	57	9
MTS-1-00	1000	1.4	64-203	1	73	12
MTS-2-00	2000	2.9	88-203	1.1	86	20
MTS-3-00	3000	4.4	100-203	1.3	106	29
MTS-5-00	5000	6.1	114-203	1.4	118	44

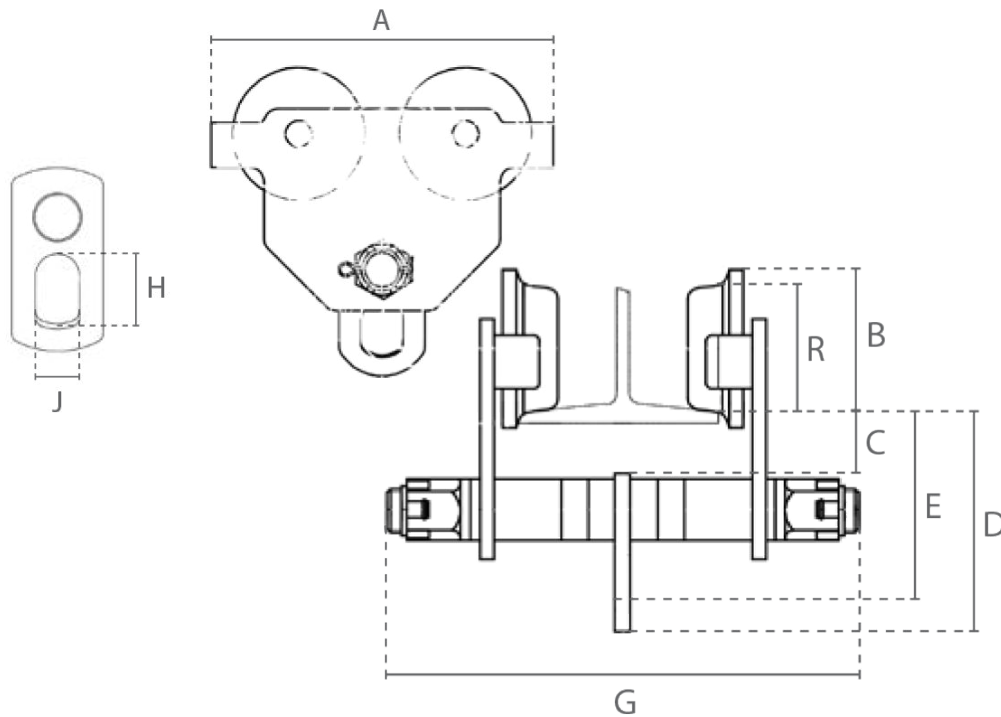

HOIST DIMENSIONS (MM)									
PRODUCT CODE	CAPACITY kg	A	B	C	D	E	G	H	J
MTS-0-50	500	199	68	30	119	104	245	32	25
MTS-1-00	1000	246	84	27	145	127	327	40	30
MTS-2-00	2000	276	97	27	171	156	345	52	38
MTS-3-00	3000	332	119	37	200	178	367	63	40
MTS-5-00	5000	377	131	38	228	198	378	75	50

TECHNICAL DATA SHEET

BALKEN INOX STAINLESS STEEL PUSH TROLLEY

MODEL: MTS

DIMENSIONS

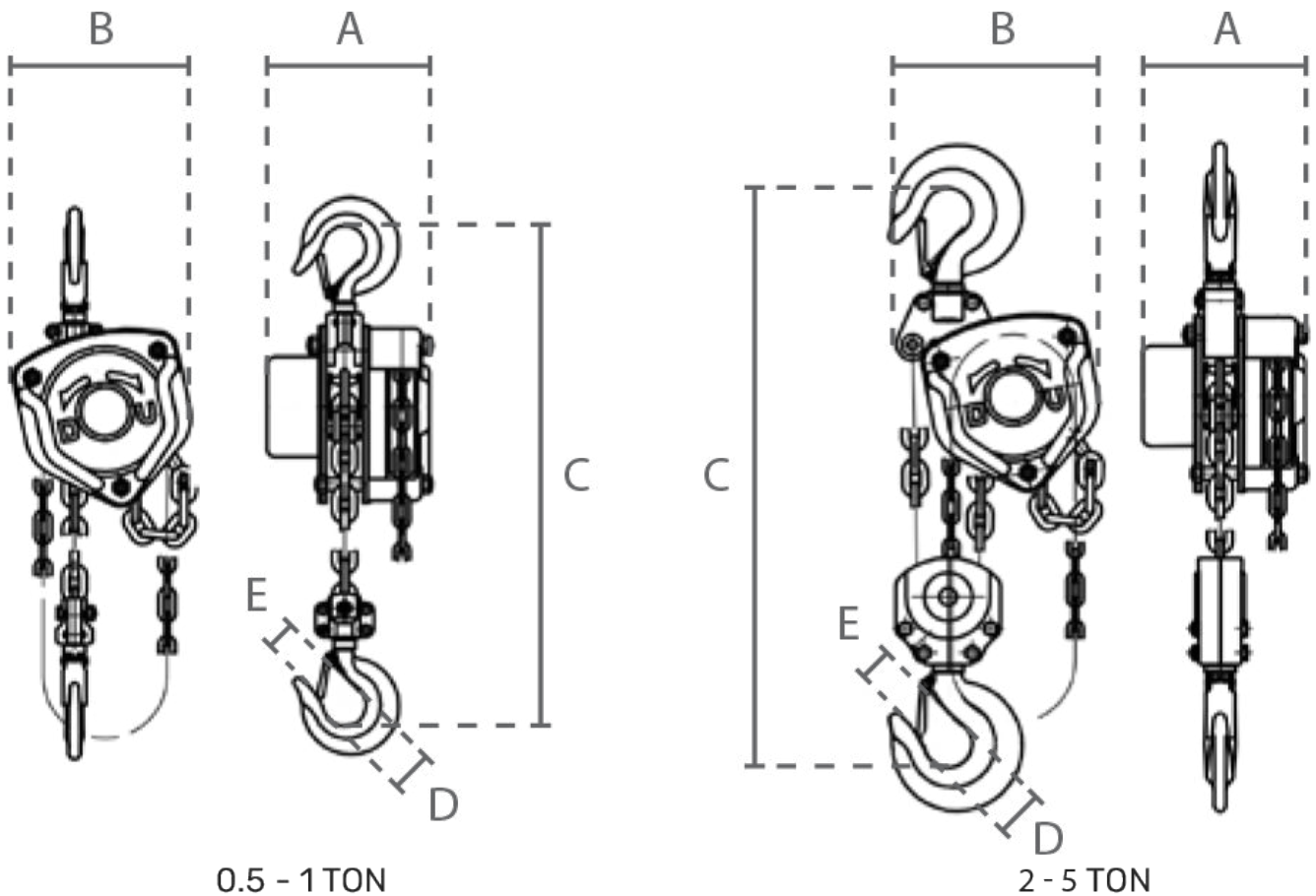

CAPACITY kg	HOIST DIMENSIONS (MM)				
	A	B	C	D	E
500	151	172	376	40	26
1000	151	172	376	40	26
2000	151	192	425	50	34
3000	173	230	565	55	39
5000	189	365	710	65	41



09 263 7725 (Auckland)
03 222 2836 (Christchurch)



sales@stratalign.co.nz
www.stratalign.co.nz



6 Harbour Ridge Drive,
Wiri, Auckland, 2104